



# METCHRO

IMAGINING, WORKING, SHINING

CUSTOM TRUCK ACCESSORIES

# MACK



# CATALOG



METCHRO

IMAGINING  
WORKING  
SHINING





- Our accessories are made of premium quality 304 stainless steel grade with non-corrosive and non-magnetic properties.
- Our Fenders are made of 430 stainless steel grade using stamping or rolling process for the best performance in the industry.
- Our lights are guaranteed for one (1) year. See our lights & accessories catalogue for details.

### Fender and mounting kit warranty

1. One (1) year warranty on parts.
2. Metchro Products Inc. will replace defective parts with new parts and will incur responsibility of shipping the replacements parts.  
2.1 Cost of labour will be paid consistend to a predetermined amount for the warranted part that is set by Metchro Inc.
3. Chrome and zinc components are not under warranty due to the hard environments they are exposed to.
4. Warranty will only be granted if the fender is properly installed using the Metchro mounting kit.
5. Warranty does not cover damages due to accidents, abuses, mishandling of the parts, improper storage, improper installation or misusage.
6. Metchro Inc. is not and will not be held responsible for any damage or violations that may occur to the vehicle on which a Metchro part is installed. This includes, but is not limited to, paint damage, body damage and law infractions. It is solely the responsibility of the client to ensure that the part is conforming to the vehicles specifications and other laws to which the vehicle must abide.
7. This warranty is applicable only to the original purchaser.

### Truck accessories warranty

1. Metchro products, excluding electrical components, are under warranty against defects in material or manship work for one (1) year from date of installation.
2. Warranty does not cover any labour cost or damages due to accidents, abuses, mishandling of the parts, improper storage, improper installation or misusage.
3. Parts with multiple components, only the defective component will be replaced.
4. This warranty is applicable only to the original purchaser
5. Metchro Inc. is not and will not be held responsible for any damage or violations that may occur to the vehicle on which a Metchro part is installed. This includes, but is not limited to, paint damage, body damage and law infractions. It is solely the responsibility of the client to ensure that the part is conforming to the vehicles specifications and other laws to which the vehicle must abide.

### Sales policies

1. All invoices will be for a minimum of 100\$.
2. All claims for shortage must be made within 10 days of receiving the product.
3. All products are F.O.B. St-Hyacinthe, Québec.
4. Terms are net 30 days.
5. All applicable taxes and charges are in extra to price list.

### Warranty

1. All returns and warranty claims must be done with the Metchro's consent and must have an authorization number.
2. Defective parts must be accompanied with a filled out claim form, the sales invoice and 4 pictures :
  - Picture of the entire truck
  - Picture to see the installation hardware
  - Picture of the problem
  - Picture proving that the rubber inslators were properly installed (Fenders only)

### Return policy

1. All products returned for credit will be subject to a 15% restocking charge.
2. All products must be returned by prepaid freight.
3. All products must be returned in its original package and in a resalable condition.

### SURFACE PREPARATION PROCEDURE FOR STICKING 3M ADHESIVE TAPE

#### IMPORTANT NOTICE : DO NOT USE BRAKE CLEANER TO CLEAN SURFACE

1. The truck should be in a environment having an ambient temperature of 15 to 30 degrees C.
2. Get the surface well cleaned with soapy water. Completely dry the surface.
3. Take a clean piece of cloth (no tissue papers), generously dip in isopropyl alcohol and clean the surface untill there is no firt on the cloth. Let the surface dry out (maximum 5 minutes).
4. Stick the accessory onto the cleaned surface very carefully and press the accessory on the surface with hands. (the accessory will stick instantly).
5. Let the accessory dry for 24 hours for maximum adhesion, before putting the truck in service.

# Metchro Catalog Index

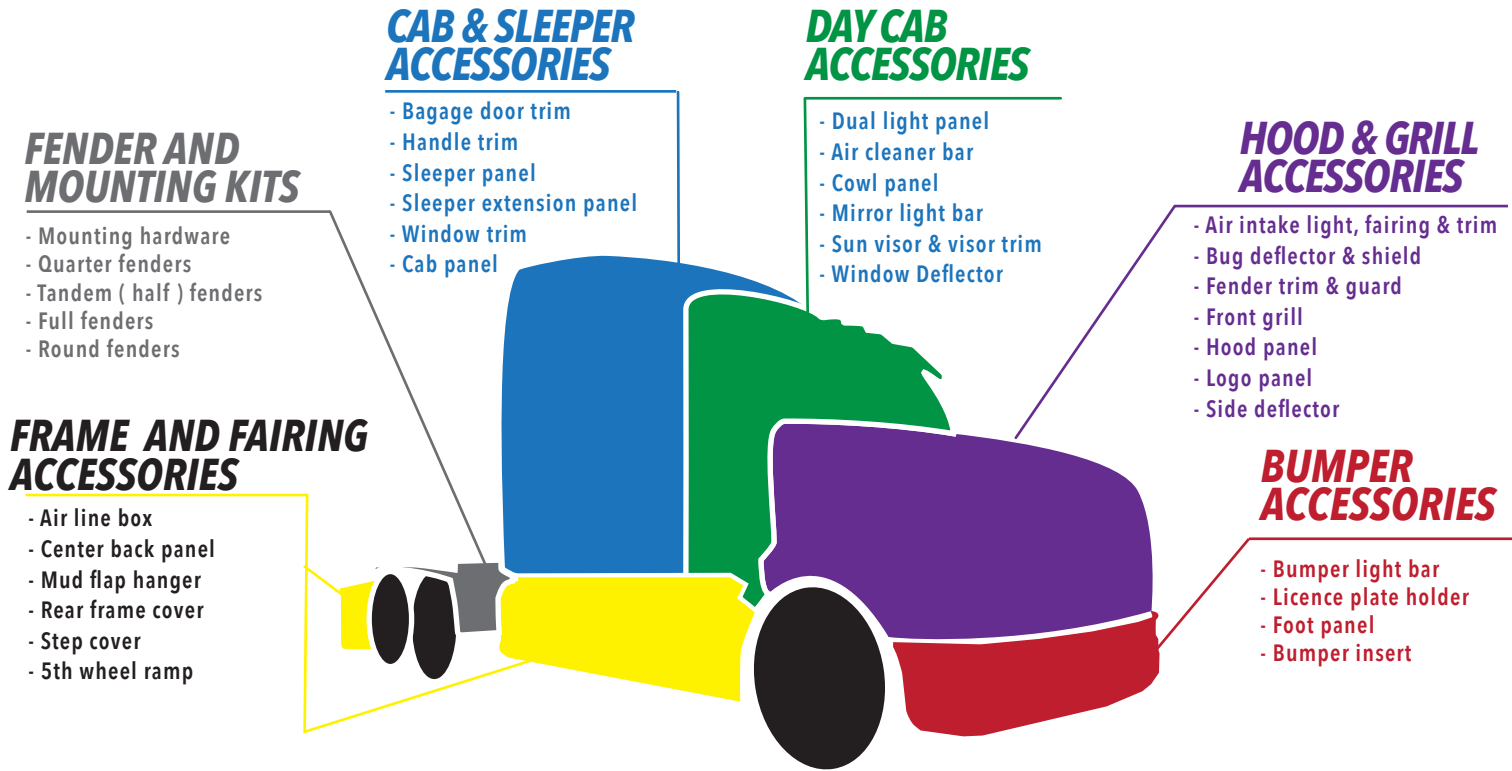

## KNOWING METCHRO'S 7000 SERIES NUMBERING SYSTEM

Each digit gives important information about the part (accessories only)

**S 7 1 5 1 0 0 3**

The "S" prefix means that the product is made with a highly polished stainless steel (304-X10).

The same part number without the "S" prefix will result in a product made with the standard stainless steel (430BA)

This digit represents a custom truck accessory

This digit represents the truck's make :

- |                   |  |
|-------------------|--|
| 0 = Caterpillar   | 6 = Mack   |
| 1 = Peterbilt     | 7 = Volvo  |
| 2 = Kenworth      | 8 = Sterling                                       |
| 3 = Freightliner  | 9 = Universal part that fits most makes and models |
| 4 = International |  |
| 5 = Western Star  |  |

This digits represents the location on the truck where the part is mounted :

- |                               |                              |
|-------------------------------|------------------------------|
| 1 = Bumper accessories        | 6 = Side fairing accessories |
| 2 = Hood & grill accessories  | 7 = Frame accessories        |
| 3 = Cab (outside) accessories | 8 = Trailer accessories      |
| 4 = Cab (inside) accessories  | 9 = Wheel accessories        |
| 5 = Sleeper accessories       | K = Multiple location kit    |

Suffix represents the type of lighting that will be used on the product :

- |         |   |                                      |
|---------|---|--------------------------------------|
| LED     | = | LED no bezel                         |
| LEDB    | = | LED with bezel                       |
| LEDCA   | = | Clear lense with amber LED           |
| LED CAB | = | Clear lense with amber LED and bezel |
| LEDCR   | = | Clear lense with red LED             |
| LEDCRB  | = | Clearlense with red LED and bezel    |
| S       | = | Made of stainless steel              |
| G       | = | Made of galvanized                   |
| P       | = | Powder coated                        |
| R       | = | Reflective tape                      |

These 3 digits identify the part itself

This digit represents how the part is sold :

- |   |   |                       |
|---|---|-----------------------|
| 1 | = | As a single unit (UN) |
| 2 | = | As a pair (PR)        |
| 3 | = | As a kit (KIT)        |

## BUMPER LIGHT BAR



**S7611001-LEDB**



**S7611003**

MODEL	PART #	DESCRIPTION
VISION & PINNACLE 2006 & UP	S7611001-LEDB	S7611001-LEDB Bumper light ( <b>28XL2A/B</b> )
VISION & PINNACLE 2006 & UP	S7611003	S7611003 Bumper bar ( <b>BLANK</b> )

## BUMPER TRIM



S7612001

ANTHEM SBA 2019 & UP

S7612001

Bumper INSERT TRIM

LED = LED no bezel / LEDB = LED with bezel / LEDC = LED Clear lens / LEDCB = LED Clear lens with and bezel / LEDF=LED Flatline / LEDFC=LED Flatline clear lens

### AIR INTAKE TRIM



**S7622001**



**S7623003**



**S7622003**



**S7622008**



**S7622009**

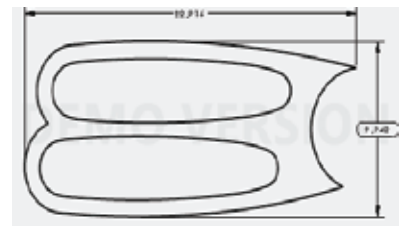

**S7622005**



**S7622012**



**S7623007**



**S7632037**

MODEL		PART #	DESCRIPTION
VISION & PINNACLE	2001 & up	S7622001	Air intake trim ( <b>PR</b> )
VISION & PINNACLE	2004 TO 2018	S7623003	Air intake insert ( <b>KIT</b> )
GRANITE	2001 TO 2017	S7622003	Air intake trim ( <b>PR</b> )
CH	2006 & UP	S7622008	Air intake trim (PR)
CH	2006 & UP	S7622009	Air intake grill (PR)
ANTHEM SBA	2019 & UP	S7622012	Air intake trim (PR)
ANTHEM	2019 & UP	S7632037	Cab & Sleeper jonction side panel SBA (PR)
VISION & PINNACLE	2006 to 2017	S7622005	Air intake trim (PR)
CH-CL-CX-GRANITE CT-CV-GU	2002 & up	S7623007	Side hood trim (PR)



**S7623002**



**S7622004**



**S7622007**



**S7622006**



**S7622011**

MODEL		PART #	DESCRIPTION
VISION	UP TO 2006	S7623002	Front fender trim ( <b>KIT</b> )
PINNACLE	2007 & UP	S7623004	Front fender trim ( <b>KIT</b> )
RAWHIDE	2008 TO 2018	S7622004	Front fender trim ( <b>PR</b> )
RAWHIDE	2015 TO 2018	S7622006	Front fender guard (PR)
ANTHEM SHORT HOOD	2019 & UP	S7622011	Front fender guard (PR)
CH SFA	2001 & UP	S7622007	Front fender guard (PR)

### HOOD & GRILL DEFLECTOR



S7623001 / S7623005



S7621003



S7621012



S7621010



S7621004



S7623008



S7621005



S7621001



S7621008



S7623009



S7621007



S7621011

MODEL	PART #	DESCRIPTION
VISION - UP TO 2006	S7623001	Hood & grill deflector ( <b>KIT</b> )
PINNACLE 2007 & UP	S7623005	Hood & grill deflector ( <b>KIT</b> )
VISION & CX UP TO 2006	S7621004	Hood deflector ( <b>UN</b> )
PINNACLE CX 2006 to 2018	S7621006	Hood deflector ( <b>UN</b> )
CH UP TO 2016	S7621001	Hood deflector ( <b>UN</b> )
GRANITE CT - 2006 TO 2010 & GRANITE GU 2011 & UP	S7621003	Hood deflector ( <b>UN</b> )
GRANITE CV 2001 & UP	S7621005	Hood deflector ( <b>UN</b> )
RAWHIDE 2008 TO 2018	S7621007	Hood deflector ( <b>UN</b> )
TITAN 2008 TO 2017	S7621008	Hood deflector ( <b>UN</b> )
RAWHIDE 2015 TO 2018	S7621010	Hood grill trim ( <b>UN</b> )
CH 2017 & UP	S7621011	Hood deflector ( <b>UN</b> )
ANTHEM SBA 2019 & UP	S7623008	Hood deflector & grill ( <b>UN</b> )
ANTHEM 2019 & UP	S7621012	Hood deflector ( <b>UN</b> )
PINNACLE long hood 2020 & UP	S7623009	Hood & Grill deflector( <b>UN</b> )
CX 2020 & UP	S7621002	Hood deflector ( <b>UN</b> )

See 3M tape surface preparation procedure on the warranty page

## VISOR LIGHT TRIM



**S7633501**

Sun visor light trim for Vision & Pinnacle trucks  
(SOLD IN KIT)  
2006 TO 2017

Valid in



**S7631004**

Granite Vision Pinnacle DAY CAB  
Sun Visor (BLANK) 11.2" DROP 2006 & UP  
TITAN 2012 & UP

Valid in



**S7632062**

MIRROR BULLDOG PLATE  
MACK ANTHEM SBA  
2018 & UP

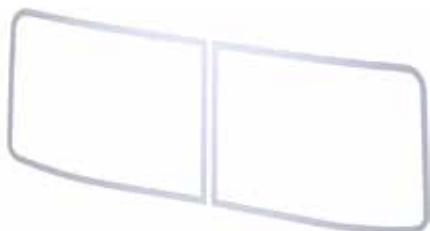

**S7631504**

Granite Vision Curve Glass  
Windshield Trim 1999 A 2017

Valid in

11.7"



**S7631007**

MACK (R) FLAT TOP 1966 TO 2005  
14 X 3/4" LIGHTS



**S7631005**

12.7" ANTHEM VISOR OEM, FIBER ROOF / HIGHT ROOF  
MIRROR ON DOOR 2019 & UP 5 LIGHTS  
USING THE ORIGINAL LIGHTS FROM THE TRUCK

Valid in



12.7"

**S7631006**

ANTHEM VISOR OEM, FIBER ROOF / HIGHT ROOF  
MIRROR ON DOOR 2019 & UP 7 LIGHTS  
USING THE ORIGINAL LIGHTS FROM THE TRUCK

Valid in



**S7631506**

VISOR STRIP OVER FIBER VISOR  
2019 & UP

Valid in



13 1/4"

**S7631001**

13 1/4" outside & 12.5" in center  
DROP FOR PINNACLE/VISION GRANITE DAY CAB 2006 & UP

Valid in

LED = LED no bezel / LEDB = LED with bezel / LEDC = LED Clear lens / LEDCB = LED Clear lens with and bezel / LEDF=LED Flatline / LEDFC=LED Flatline clear lens



VISION GRANITE PINNACLE RAWHIDE ANTHEM	STYLE	YEAR	KICK PLATE
	UPPER KICK PLATE PANELS W/O FAIRING	ALL YEARS	S7632014 <i>(WITH OLD MACK LOGO)</i>
			S7632028 <i>(WITH NEW MACK LOGO - ARIAL)</i>
			S7632017 <i>(W/OUT LOGO)</i>
			S7662048



PINNACLE VISION	STYLE	YEAR	KICK PLATE
	KICK PLATE PANELS WITH FAIRING	ALL YEARS	S7662001 <i>(UPPER KICK PLATE) 2008 TO 2017</i>
			S7662002 <i>(LOWER KICK PLATE) 2008 TO 2017</i>
			S7662003 <i>(UPPER KICK PLATE) 2014 &amp; UP</i>



ANTHEM	KICK PLATE PANELS WITH FAIRING	2019 & UP	S7662006
--------	-----------------------------------	--------------	----------



LED = LED no bezel / LEDB = LED with bezel / LEDC = LED Clear lens / LEDCB = LED Clear lens with and bezel / LEDF=LED Flatline/ LEDFC=LED Flatline clear lens

### ANTHEM CAB & SLEEPER PANEL WITH 3/4" LIGHTS UNDER BAR

DAY CAB	YEAR	CAB PANELS	CAB EXTENTION	SLEEPER PANEL	SLEEPER EXTENTION
<b>ANTHEM SBA</b> DAY CAB SHORT HOOD 2" PANELS	2020 & UP	<b>S7632047-LED</b> 2" Cab Panel 18 3/4" LIGHTS 1 block heater hoole <b>S7632046-LED</b> 2" Cab Panel 18 3/4" LIGHTS	<b>S7632036-LED</b> 2" Cab Panel Ext 10 3/4" Light	<b>S7652020-LED</b> 2" Sleeper Panel 12 3/4" LIGHTS	<b>S7652021-LED</b> 2" Sleeper Panel Ext 8 3/4" Light w/out skirt
<b>PINNACLE</b> SFA	2019 & UP	<b>S7632044-LED</b> 1 block heater hoole <b>S7632044-LED</b> 2 block heater hoole			

1" 1/2' PANELS

WITH SLEEPER

ANTHEM SBA	YEAR	CAB PANELS	CAB EXTENTION	SLEEPER PANEL	SLEEPER EXTENTION
<b>EXHUST UNDER SHORT HOOD WITH FAIRING</b>	2019 & UP	<b>S7632038-LED</b> 1"1/2 X 35.5 Cab Panel 13 3/4" LIGHTS 2 block heater hooles	<b>S7632039-LED</b> 1"1/2 X 19.6" Cab Panel Ext 10 3/4" Light	<b>S7652023-LED</b> 1"1/2 Sleeper Panel 12 3/4" LIGHTS with skirt	<b>S7652024-LED</b> 1"1/2 Sleeper Panel Ext 8 3/4" Light with skirt

ANTHEM SBA	YEAR	CAB PANELS	CAB EXTENTION	SLEEPER PANEL 52::	SLEEPER EXTENTION
<b>SHORT HOOD 2" PANELS</b>	2019 & UP	<b>S7632035-LED</b> 2" Cab Panel 12 3/4" LIGHTS 2 block heater hooles	<b>S7632036-LED</b> 2" Cab Panel Ext 10 3/4" Light	<b>S7652020-LED</b> 2" Sleeper Panel 12 3/4" LIGHTS	<b>S7652021-LED</b> 2" Sleeper Panel Ext 8 3/4" Light w/out skirt





2' 1/2' PANELS WITH OUT FAIRING AND WITH OUT SIDE MARKER FLASHER WITH 4.5/8" SLEEPER EXHAUST UNDER SHORT HOOD

ANTHEM SBA	YEAR	CAB PANELS	CAB EXTENTION	SLEEPER PANEL 48"	SLEEPER EXTENTION
<b>2 1/2" PANELS</b> 1 BLOCK HEATHER HOLE	2019 & UP	<b>S7632065-LED</b> 2 1/2" Cab Panel 33 x 2 1/2 15 x 3/4" lighths	<b>S7632067</b>	<b>S7652026-LEDC</b> 4"5/8 Sleeper Panel 12 3/4" LIGHTS	
<b>ANTHEM SBA</b> 2 1/2" PANELS 2 BLOCK HEATHER HOLE	2019 & UP	<b>S7632066-LED</b> 2 1/2" Cab Panel 33 x 2 1/2 15 x 3/4 lighths	<b>S7632067</b>	<b>S7652026-LEDC</b> 4"5/8 Sleeper Panel 12 3/4" LIGHTS	



3/4" lights are under the panel

LED = LED no bezel / LEDB = LED with bezel / LEDC = LED Clear lens / LEDCB = LED Clear lens with and bezel / LEDF=LED Flatline / LEDFC=LED Flatline clear lens

	STYLE	CAB PANEL	SLEEPER PANEL	SLEEPER EXT. PANEL
<b>VISION PINNACLE ALL YEARS</b>	<b>BLANK</b>	<b>S7632016</b> 39.5" x 3" 2006 & UP	<b>S7652016</b> 65.5" x 3" 2006 TO 2017	<b>S7652010</b> 2006 TO 2017
	<b>OVAL</b>	<b>S7632025-LED</b> 33.75" x 3" ALL YEAR <b>S7632002-LED</b> 39.5" x 3" 2006 & UP	<b>S7652001-LED</b> 65.5" x 3" 2006 TO 2017	<b>S7652002-LED</b> 2006 TO 2017
	<b>ROUND 3/4" BULLET LIGHT</b>	<b>S7632034-LED</b> 39.5" x 3" 2006 TO 2017	<b>S7652018-LED</b> 65.5" x 3" 2006 TO 2017	<b>S7652019-LED</b> 2006 TO 2017
<b>PINNACLE SFA 2019</b> WITH OUT FAIRING LIGHTS UNDER THE PANEL	<b>ROUND</b>	<b>S7632040-LED</b> 2 BH hole 39.5" x 2" 2019 & UP	<b>S7652020-LED</b> 65.5" x 3" 2019 & UP	<b>S7652021-LED</b> 2019 & UP
	<b>3/4"</b>	<b>S7632041-LED</b> 1 BH hole 39.5" x 2" 2019 & UP	<b>S7652020-LED</b> 65.5" x 3" 2019 & UP	<b>S7652021-LED</b> 2019 & UP
<b>PINNACLE SFA 2019</b> WITH OUT FAIRING rear exhaust	<b>BLANK</b>	<b>S7632040</b> 2 BH hole 39.5" x 2" 2019 & UP	<b>S7652020</b> 65.5" x 3" 2019 & UP	<b>S7652021</b> 2019 & UP
		<b>S7632041</b> 1 BH hole 39.5" x 2" 2019 & UP	<b>S7652020</b> 65.5" x 3" 2019 & UP	<b>S7652021</b> 2019 & UP
<b>PINNACLE CHU 2008 &amp; UP</b>	<b>STYLE</b>	<b>CAB PANEL</b>	<b>SLEEPER PANEL</b>	
	<b>BLANK</b>	<b>S7632019</b> 2 BH hole 48" x 3.5" 2008 & UP	<b>S7652011</b> 65" x 3.5" 2008 TO 2017	 <b>S7632034-LED</b> Cab Panel for Vision / Pinnacle 3/4" oval lights 2006 TO 2017
		<b>S7632024</b> 1 BH hole 48" x 3.5" 2008 & UP		
<b>ROUND 3/4"</b>	<b>S7632020-LED</b> 2 BH hole 48" x 3.5" 2008 & UP <b>S7632031-LED</b> 2 BH hole 48" x 3.5" 2008 & UP	<b>S7652012-LED</b> 65" x 3.5" 2008 TO 2017		
<b>PINNACLE CV ALL YEARS</b>	<b>STYLE</b>	<b>CAB PANEL</b>		
	<b>OVAL</b>	<b>S7632011-LED</b> 46.5" X 3" 2001 & UP	 <b>S7632011-LED</b> Cab Panel for Pinnacle CV Trucks 2001 & UP	
<b>VISION CXV 613 WITH FAIRING 2014 TO 2017</b>	<b>STYLE</b>	<b>CAB PANEL</b>		
	<b>BLANK</b>	<b>S7632021</b> 40" 2014 TO 2017	 <b>S7652002-LED</b> Sleeper Ext. Panel for Vision & Pinnacle Trucks 2006 TO 2017	
<b>GRANITE GU 2006 &amp; UP</b>	<b>STYLE</b>	<b>CAB PANEL</b>		
	<b>BLANK</b>	<b>S7632022</b> 40.25" 2006 & UP	 <b>S7652012-LED</b> Sleeper Panel for Pinnacle CHU Trucks 2008 TO 2017	

LED = LED no bezel / LEDB = LED with bezel / LEDC = LED Clear lens / LEDCB = LED Clear lens with and bezel / LEDF=LED Flatline / LEDFC=LED Flatline clear lens

## SLEEPER WINDOW - AND DOOR TRIM



**S7652009**  
Baggage door trim  
VISION - PINNACLE 2006 to 2017

ANTHEM (PR) 2019 & up



**S7652022**  
Sleeper Windowtrim  
ANTHEM 2019 & UP(PR)



**S7631505**  
REAR CAB WINDOW TRIM  
CH-CL-CX-CT-CV-GU  
2000 & UP

## CAB TRIM



**S7652004**  
Sleeper window trim  
VISION - PINNACLE (PR)  
2006 TO 2017



**S7653001**  
Sleeper vent trim  
VISION - 1999 to 2017  
PINNACLE (KIT)  
2001 & up



**S7951003**  
Sleeper vent trim  
ALL MODELS



**S7651003 - RAWHIDE LOGO**  
Rear sleeper panel  
RAWHIDE 2015 TO 2018



**S7633002**  
Door handle trim  
all ex:Rawhide



**S7653002**  
Baggage door handle trim  
RAWHIDE 2015 TO 2018

## FRONT KICK PANEL - FOR VISION CX 613 WITH FAIRING

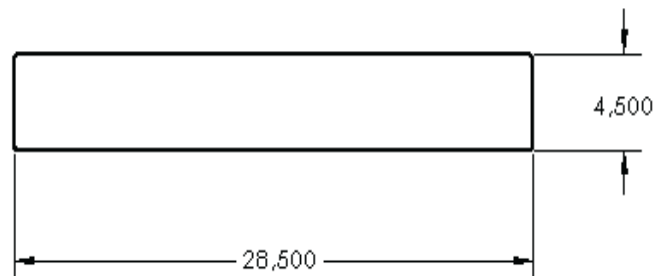

**S7662005 28.5" x 4.5"**  
Front Kick Panel for Vision CX Trucks  
2014 & UP.

### DOOR TRIM - FOR MULTIPLE MACK TRUCKS



S7631501 & S7632008



S7633001



S7633003



S7632013



S7632027



S7632010



S7632033



S7632048

MODEL	YEARS	PART #	DESCRIPTION
GRANITE	2001 & UP	<b>S7632010</b>	Door logo trim (PR)
GRANITE VISION & PINNACLE	2006 & UP	<b>S7632013</b>	Window deflector (PR)
GRANITE VISION & PINNACLE ANTHEM	2006 & UP	<b>S7633001</b>	Door handle trim (KIT)
VISION	ALL YEARS	<b>S7632008</b>	Door logo trim (PR)
PINNACLE PINNACLE CH GRANITE VISION ANTHEM	2006 & UP ANTHEM 2019 & UP	<b>S7632018</b> <small>EXP: TITAN</small>	Window deflector (PR) WITH OUT CONVEX MIRROR
ALL MODELS EXCEPT RAWHIDE	ALL YEARS	<b>S7633002</b>	Door handle trim (KIT)
GRANITE ANTHEM	GRANITE 2002 & UP ANTHEM 2019 & UP	<b>S7632027</b>	Door window trim (PR)
RAWHIDE	2005 TO 2018	<b>S7633003</b>	Door handle trim (KIT)
GRANITE, PINNACLE, TITAN, VISION	2008 TO 2018 Vision 2012 TO 2018	<b>S7632033</b>	Window deflector (PR)
CH	2006 & UP	<b>S7632023</b>	Window shade Window deflector (PR)(PR)
VISION	2006 TO 2017	<b>S7631501</b>	Window trim (one side)
ANTHEM	2019 & up	<b>S7632048</b>	Kik panel (PR)

### WINDOW DEFLECTOR



S7632063 POUR CONVEX  
PINNACLE-GRANITE-VISION- 2006 & UP  
ANTHEM 20219 & UP



S7632018 SANS CONVEX  
PINNACLE-GRANITE-VISION- 2006 & UP  
ANTHEM 20219 & UP

### REVOLVING LIGHT BRACKET

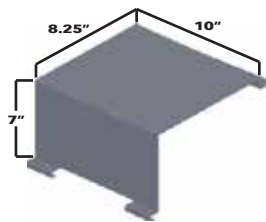

S7632060

MODEL	PART #	DESCRIPTION
GARNITE, CT & CV FLAT TOP 2001 & UP	S7632060	Strobe light bracket ( <b>PR</b> )

FOR OTHER MODELS, LOOK AT THE UNIVERSAL CATALOG

### REAR FRAME COVER



**S7671001**  
**REAR FRAME COVER 6"**  
**PINNACLE VISION**  
**ALL YEARS**



**S7671005**  
**REAR FRAME COVER 6.3"**  
**RAWHIDE**  
**2015 TO 2018**

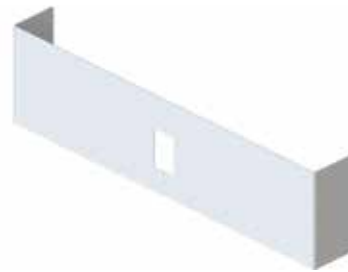

**S7971006 BATTERIE**  
**COVER FOR PINNACLE**  
**COVER FOR PINNACLE**  
**SBA 2019 & UP**



**S7672001**  
**ALL MODELS**  
**ALL YEAR**

### ANTI-SAIL FLAP PLATE

### MUD FLAP WEIGHTS

**BOLTED**



**7972043-S**



**7972044-S**



**7972045-S**

### AIR TANK COVER



**S7661001**  
**PINNACLE - VISION AIR TANK COVER**



**S7662007**  
**FAIRING STAINLESS EXTENTION**  
**ANTHEM SBA 2019 & UP**



**IMAGINING  
WORKING  
SHINNING**



## CUSTOM TRUCK ACCESSORIES

**6755 Choquette avenue, local #1  
St-Hyacinthe, QC, Canada  
J2S 8L2**

**TEL : 450 223-1753  
FAX : 450 223-1300  
TOLL FREE : 1 877 223-1753**

**METCHRO.COM  
INFO@METCHRO.COM**